



## Peckett Square, N5 2PB

£325,000 Leasehold



A bright and spacious one double-bedroom flat, on the upper floor within a popular purpose-built mansion block in one of Highbury's most desirable locations. The property is in good condition throughout and comprises a bright reception room surrounded by sash windows leading through to a corner set modernised fitted kitchen, refurbished full bathroom and a generous double bedroom. Peckett Square is very well located for excellent local amenities, including Highbury Barn on your doorstep & the beautiful parks of Highbury Fields and Clissold Park within a short walk. The property benefits from excellent transport links, including Arsenal, Drayton Park, Highbury & Islington, Canonbury and

- One Double Bedroom
- Communal Garden & Allotment
- 425sqft/39.5sqm
- Next to Highbury Barn
- EPC Rating D
- A short walk to Highbury Fields
- Great Location
- Excellent Transport Links

*Highbury*

To arrange a viewing please contact:

Highbury office

90 Highbury Park  
London, N5 2XE

T (0)20 7354 9111  
E [highbury@davidandrew.co.uk](mailto:highbury@ davidandrew.co.uk)



## Peckett Square, N5

Approximate Gross Internal Area = 425 sq ft / 39.5 sq m

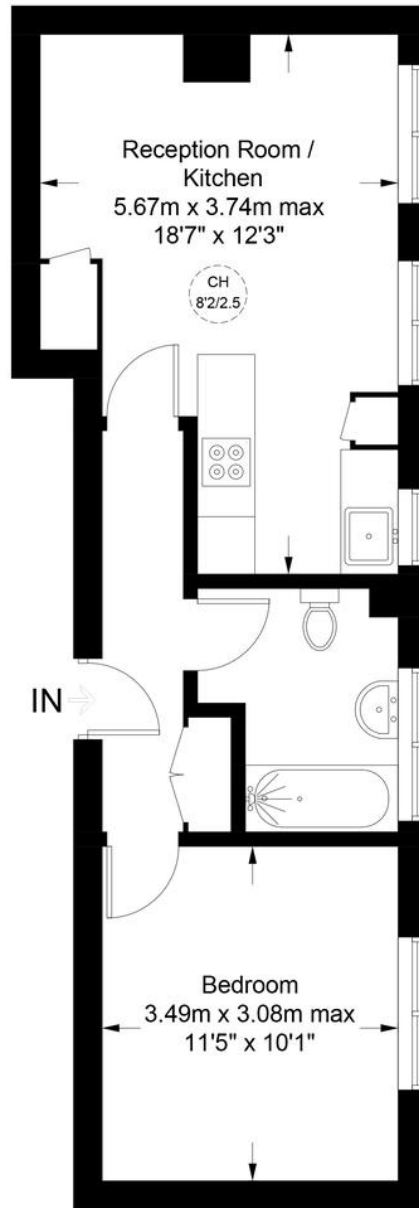

### Third Floor



**Certified  
Property  
Measurer**

This plan is for layout guidance only. Not drawn to scale unless stated. Windows and door openings are approximate. Whilst every care is taken in the preparation of this plan, please check all dimensions, shapes and compass bearings before making any decisions reliant upon them. (ID1031605)

**DAVID  
ANDREW** | your most valuable asset



#### Agent's Note:

Whilst Care has been exercised in the preparation of these particulars, statements about the property must not be relied upon as representations of statement or fact. Prospective applicants must make and rely upon their own enquiries and those of their professional representatives. The company accepts no liability for any error contained in these particulars.

#### Archway office

671 Holloway Road  
London, N19 5SE

T (0)20 7619 3750

E archway@davidandrew.co.uk

#### Highbury office

90 Highbury Park  
London, N5 2XE

T (0)20 7354 9111

E highbury@davidandrew.co.uk

#### Stroud Green office

167 Stroud Green Road  
London, N4 3PZ

T (0)20 7281 2000

E stroudgreen@davidandrew.co.uk