



Tollington Way, N7 6RE

£1,600 pcm



Tollington Way

£1,600 pcm

A lovely well-presented one double bedroom period conversion property, in great condition. Located within reasonable distance of Holloway & Finsbury Park tube stations.

Property features include a spacious open plan kitchen & reception room, laminate flooring throughout, large windows offering natural light, original kitchen & bathroom features, furnishings (if required) in great condition offering a homely welcoming feel, two large storage rooms separate to the apartment, gas central heating and on street permitted parking available.

Tollington Way is ideally located within easy reach of an array of trendy shops and restaurants, also providing excellent transport connections into central London via bus routes & tube stations (Holloway Road & Finsbury Park). Offered furnished or unfurnished - the landlord is flexible. Available 6th of March.

- One Double Bedroom
- Open Plan
- Excellent Condition
- Permit Parking
- Comprising 451.55SQFT/41.95SQM
- EPC rating: D
- Flexible Furnishings
- Available 6th of March





Notes

Archway Office

671 Holloway Road
London, N19 5SE

T (0)20 7619 3750

Highbury Office

90 Highbury Park
London N5 2XE

T (0)20 7354 9111

Stroud Green Office

167 Stroud Green Road
London N4 3PZ

T (0)20 7281 2000

General Contact

E info@davidandrew.co.uk

W www.davidandrew.co.uk

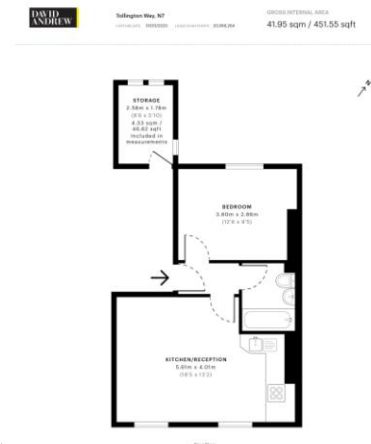

Whilst care has been exercised in the preparation of these sales particulars, statements about the property must not be relied upon as representations of statements or fact. Prospective purchasers must make and rely upon their own enquiries and those of professional representatives. The company accept not liability for any error contained in these particulars.