



Hatchard Road, N19 4NH

£475,000
Leasehold



Hatchard Road

£475,000

Leasehold

A delightful, one-bedroom, garden flat offering 467 square feet of living space on a quiet, residential street. This charming property comprises a spacious living room with period features, a fully-fitted kitchen, modern bathroom and a large bedroom overlooking a private garden to the rear. The property has been recently updated to include new, double-glazed windows, a new roof and redecoration of the communal areas.

The flat is well-situated for access to the open spaces of Hampstead Heath, Finsbury Park and Waterlow Park and is within walking distance of Archway underground (Northern Line), Upper Holloway overground station and the shops, restaurants, cafes and amenities in and around Holloway Road.

- 467 sqft / 43.4 sqm
- One bedroom
- Private garden
- Modern bathroom
- Fully-fitted kitchen
- Leasehold
- Good transport links
- Quiet location







Hatchard Road, London, N19

Approximate Area = 467 sq ft / 43.4 sq m

For identification only - Not to scale

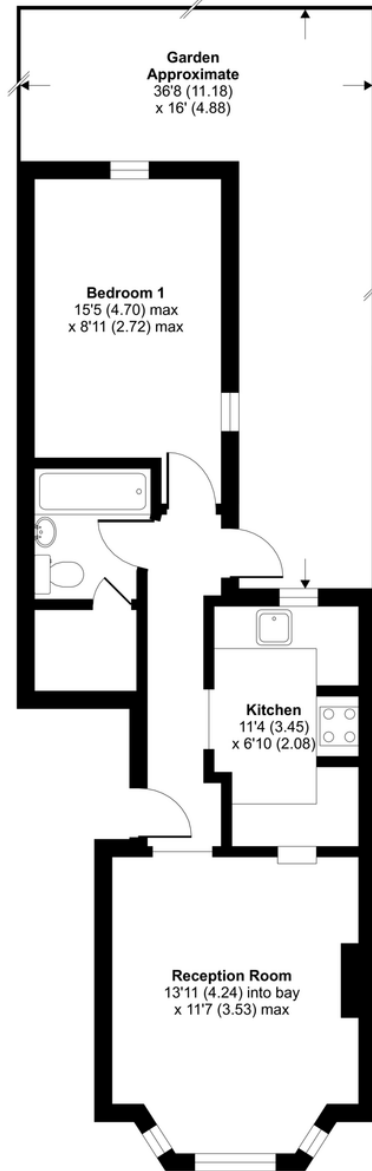

GROUND FLOOR



Floor plan produced in accordance with RICS Property Measurement Standards incorporating International Property Measurement Standards (IPMS2 Residential). © nichecom 2021. Produced for David Andrew. REF: 796976



DAVID ANDREW

your
most
valuable
asset

Archway Office

671 Holloway Road
London, N19 5SE

T (0)20 7619 3750

Highbury Office

90 Highbury Park
London N5 2XE

T (0)20 7354 9111

Stroud Green Office

167 Stroud Green Road
London N4 3PZ

T (0)20 7281 2000

General Contact

E info@davidandrew.co.uk

W www.davidandrew.co.uk

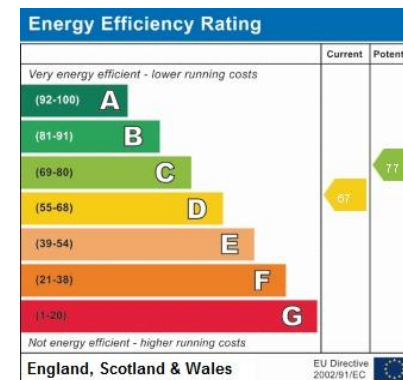

Agent's Note:

Whilst Care has been exercised in the preparation of these sales particulars, statements about the property must not be relied upon as representations of statements or fact. Prospective purchasers must make and rely upon their own enquiries and those of professional representatives. The company accept not liability for any error contained in these particulars.

