



Fairbridge Road, N19 3HY

Guide Price £395,000
Leasehold



Fairbridge Road

Guide Price £395,000

Leasehold

A charming two bedroom apartment comprising 492sqft / 45.7sqm on the first floor of an attractive period house.

This delightful property located on a popular and quiet tree-lined road in the heart of Archway is presented in good condition and benefits from an abundance of natural light throughout the apartment.

Conveniently located within close proximity to bus connections, Archway underground (Northern Line) and Upper Holloway Overground stations and a great selection of local shops, popular pubs, bars and restaurants.

- 492 SQFT / 45.7 SQM
- Two Bedrooms
- First Floor Apartment
- Reception Room/Kitchen
- Quiet Tree-Lined Road
- Close Proximity to Local Amenities
- Chain Free
- Share of Freehold Possible to Acquire





Fairbridge Road, London, N19
 APPROX. GROSS INTERNAL FLOOR AREA 492 SQ FT 45.7 SQ METRES

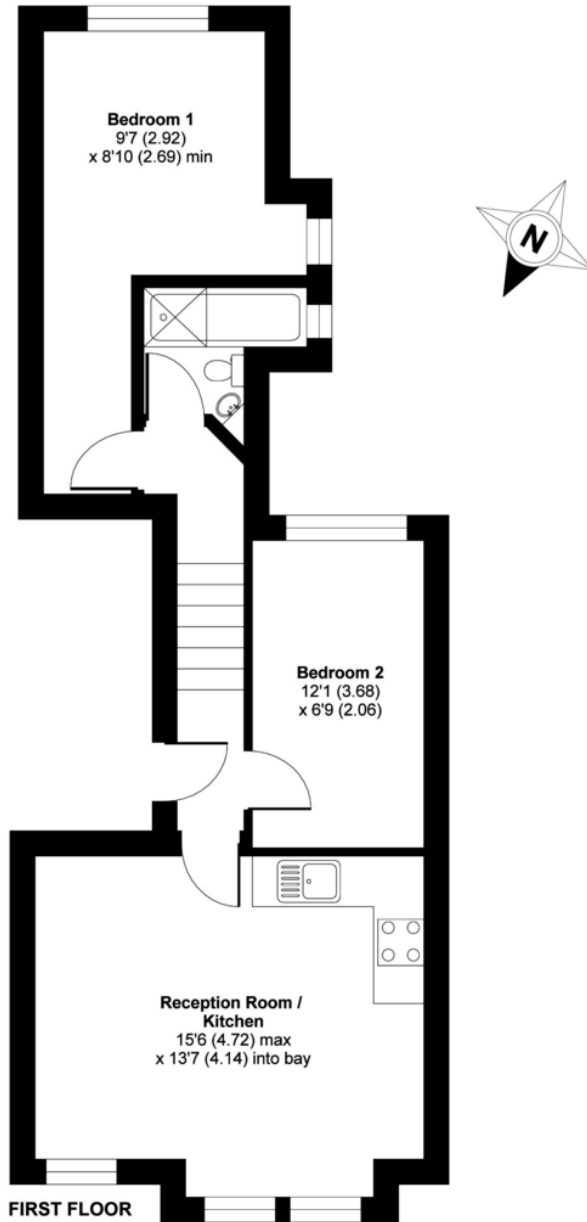

DAVID ANDREW | your most valuable asset

Archway Office

671 Holloway Road
 London, N19 5SE

T (0)20 7619 3750

Highbury Office

90 Highbury Park
 London N5 2XE

T (0)20 7354 9111

Stroud Green Office

167 Stroud Green Road
 London N4 3PZ

T (0)20 7281 2000

General Contact

E [info@davidandrew.co.uk](mailto:info@ davidandrew.co.uk)

W www.davidandrew.co.uk

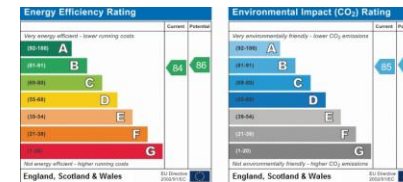

Agent's Note:

Whilst Care has been exercised in the preparation of these sales particulars, statements about the property must not be relied upon as representations of statements or fact. Prospective purchasers must make and rely upon their own enquiries and those of professional representatives. The company accept not liability for any error contained in these particulars.



Whilst every attempt has been made to ensure the accuracy of the floor plan contained here, measurements of doors, windows and rooms are approximate and no responsibility is taken for any error, omission or misstatement. These plans are for representation purposes only as defined by RICS Code of Measuring Practice and should be used as such by any prospective purchaser. Specifically no guarantee is given on the total square footage of the property if quoted on this plan. Any figure given is for initial guidance only and should not be relied on as a basis of valuation.

Copyright nichecom.co.uk 2018 Produced for David Andrew REF : 326217

