



Hornsey Lane, N6 5LW

£430,000 Leasehold



Located close to Highgate, Crouch End and Archway borders is this two bedroom, with a study room lower ground flat which is offered for sale in good decorative order. Internally the property consists of three bedrooms, modern bathroom, bright living area and a separate kitchen. The flat is within close distance to both Whitehall Park and Coleridge primary schools.

- Leasehold - 106 years -
- 605 SQFT
- 56.2 SQ meters
- 2 Bedroom Apartment
- Short walk to Archway Tube
- Ideal First time buyers
- Close to Whitehall Park primary
- Study Room / 3rd Bedroom

Hornsey Lane, London, N6

APPROX. GROSS INTERNAL FLOOR AREA 605 SQ FT 56.2 SQ METRES

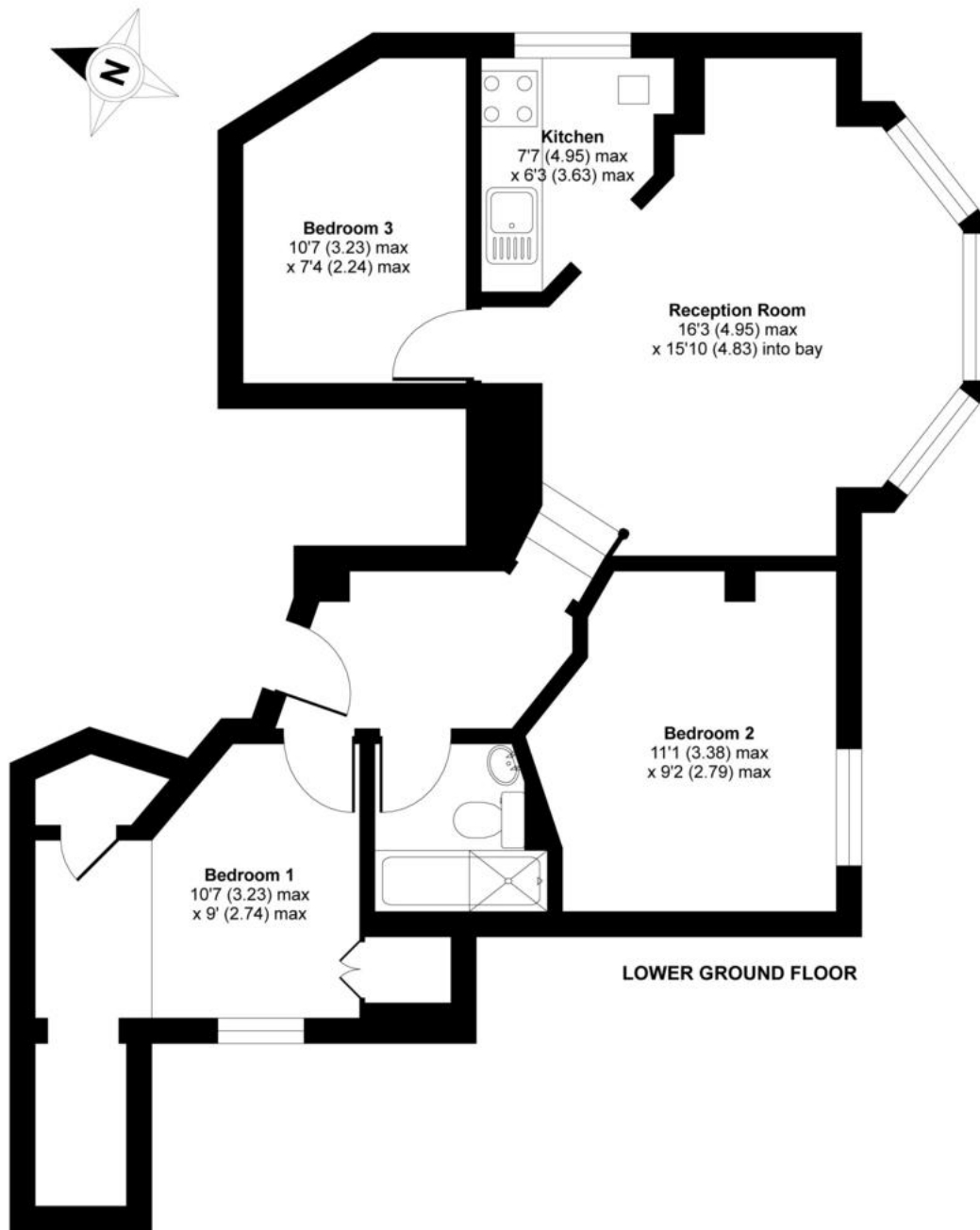

Whilst every attempt has been made to ensure the accuracy of the floor plan contained here, measurements of doors, windows and rooms are approximate and no responsibility is taken for any error, omission or misstatement. These plans are for representation purposes only as defined by RICS Code of Measuring Practice and should be used as such by any prospective purchaser. Specifically no guarantee is given on the total square footage of the property if quoted on this plan. Any figure given is for initial guidance only and should not be relied on as a basis of valuation.

Copyright nichecom.co.uk 2016 Produced for David Andrew REF : 120782



Agent's Note:

Whilst Care has been exercised in the preparation of these particulars, statements about the property must not be relied upon as representations of statement or fact. Prospective applicants must make and rely upon their own enquiries and those of their professional representatives. The company accepts no liability for any error contained in these particulars.

Archway office

671 Holloway Road
London, N19 5SE

T (0)20 7619 3750
E archway@davidandrew.co.uk

Highbury office

90 Highbury Park
London, N5 2XE

T (0)20 7354 9111
E highbury@davidandrew.co.uk

Stroud Green office

167 Stroud Green Road
London, N4 3PZ

T (0)20 7281 2000
E stroudgreen@davidandrew.co.uk